

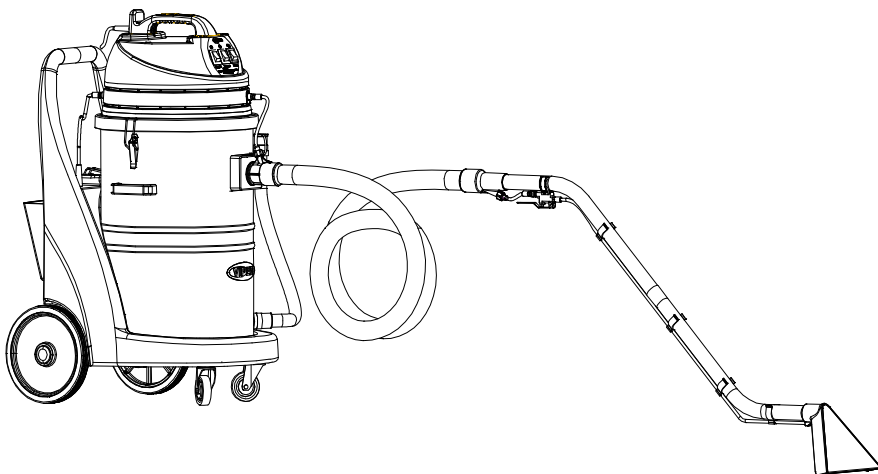

75L DRY & WET CARPET CLEANER / NETTOYANT MOQUETTE EAU ET POUSSIERE
75L/NETTOYANT MOQUETTE EAU ET POUSSIERE 75L/ 75L ΜΗΧΑΝΗΜΑ ΣΤΕΓΝΟΥ
& ΥΓΡΟΥ ΚΑΘΑΡΙΣΜΟΥ ΧΑΛΙΩΝ/ΜΟΚΕΤΩΝ /75L SZÁRAZ ÉS NEDVES
SZŐNYEGTISZÍTÓ/BATTITAPPETO A SECCO & UMIDO DA 75L/75L URZĄDZENIE DO
CZYSZCZENIA DYWANÓW NA MOKRO I NA SUCHO/75L LIMPADOR DE CARPETE
SECO E MOLHADO / ASPIRATOR PENTRU CURĂȚARE UMEDĂ & USCATĂ 75L / 75L
СУХОЙ & ВЛАЖНЫЙ ОЧИСТИТЕЛЬ КОВРОВ/75L ASPIRADORA PARA LIMPIADO EN
SECO Y MOJADO/75L KURU& ISLAK HALI TEMİZLEYİCİ /75L ΠΡΑΧΟΣΜΥΚΑΧΚΑ ΖΑ
ΣΥΧΟ Ι ΜΟΚΡΟ ΠΟΧΙΣΤΒΑΗΕ/75L VYSAVAČ NA MOKRO-SUCHÉ ČIŠTĚNÍ
KOBERCŮ/75-L-TROCKEN- UND NASS-TEPPICHREINIGER/75L DROOG & NAT
CARPET REINIGER/75L ČISTILEC ZA SUHO IN MOKRO ČIŠČENJE

(CAR275 OWNER'S MANUAL)



VA83608-010

ev.2014(03-06)

ENGLISH	Operation Guidelines.....	3-6. 7-10
TÜRKÇE	Kullanım Talimatları.....	3-6. 11-14

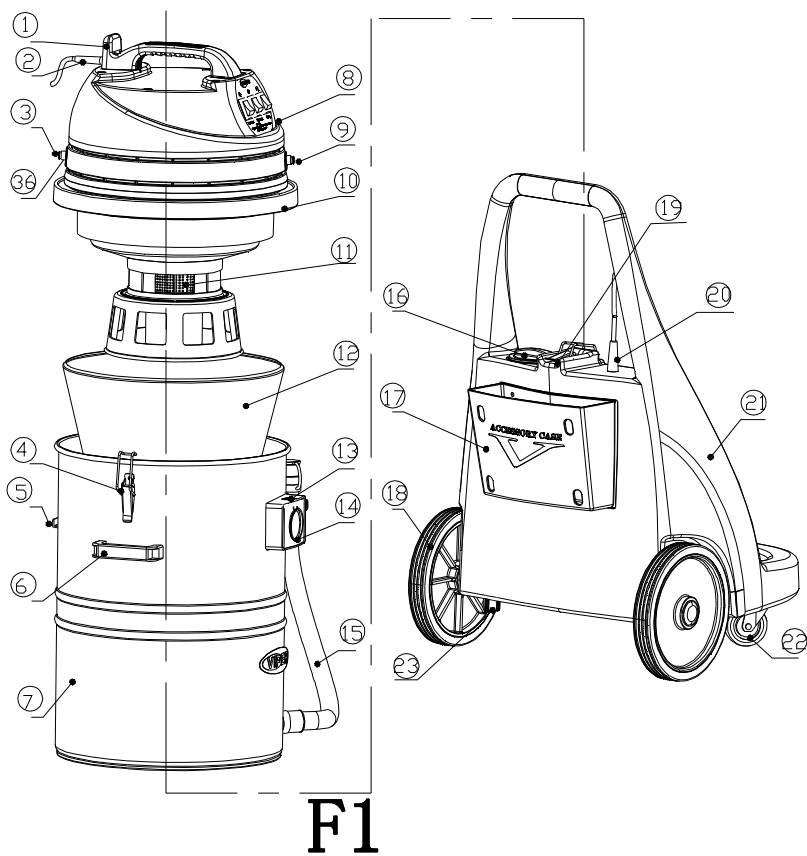

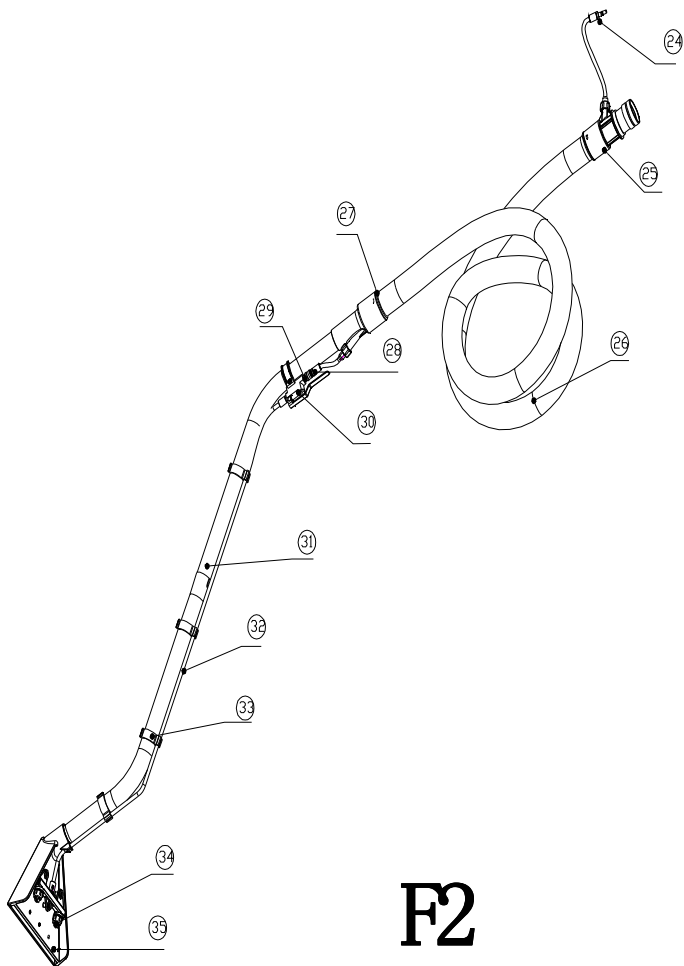

F2

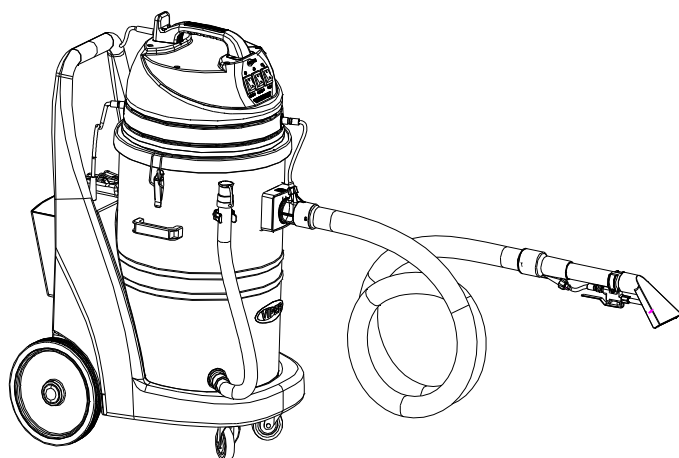
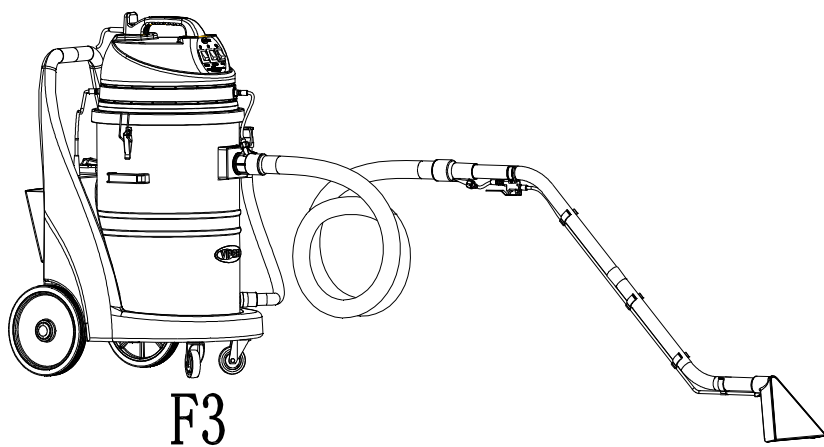

F4

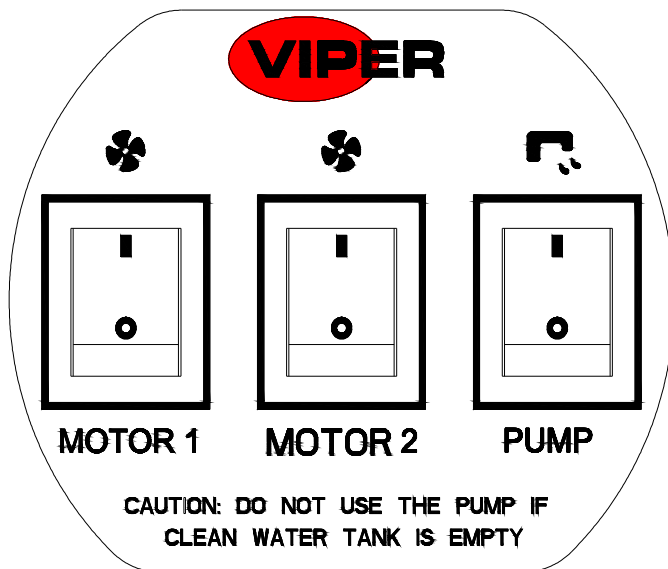

F5

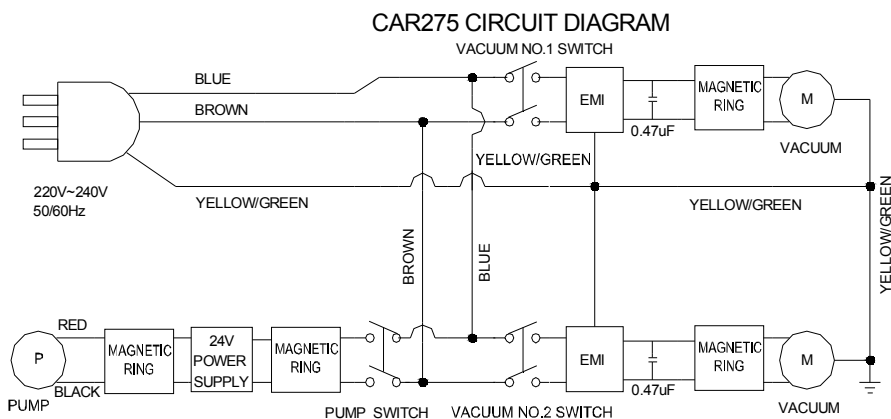

Introduction:

This manual is to be used for an understanding of Viper and a mastery of the operation and use of CAR275.

This manual should be read thoroughly before use.

This device is a commercial carpet cleaner.

Description of the construction of the device

For parts diagrams of the construction of CAR275, refer to “F1”Diagram on Page 3 and “F2” Diagram on Page 4.

1. Headpiece handle hook 2. Power cord 3. Headpiece water pump inlet fast female connector 4. Water tank fastener 5. Drain water tank hind fastener hook 6. Tank handle 7. Stainless steel drain water tank 8. On/off switch panel 9. Headpiece water pump outlet fast female connector 10. Headpiece assembly 11. Stainless steel foam protection mesh 12. Dust filter 13. Suction hose base button 14. Suction hose base 15. Draining hose 16. clean water tank lid 17. Spare tank 18. 10-inch hind wheel 19. Water tank fastener 20. Clean water tank hose fast male connector component 21. 25-liter clear water tank base 22. 3.5”directional wheel 23. Water drainage lid 24. Male connector component for the base of the suction hose 25. Connector for the corrugated hose at the base of the suction hose 26. Corrugated hose 27. Connector for the corrugated hose of the metal elbow end 28. Fast male connector of the metal elbow end 29. Threaded fast female connector of the on/off switch panel 30. Control valve 31. Metal elbow end component 32. PU water hose 33. PU water hose retaining clips 34. 110° nozzle 35. 10” transparent triangular rake component 36. Unscrewing sliding button

Instructions

1. Fill the clean water tank with an appropriate quantity of clean water or soluble low foaming solution with cleaning agents (Attention: No dirt and sand grains should be present). The soluble solution to be used to fill the clean water tank must be kept at 5 cm below the water inlet of the clean water tank, in order to avoid spilling when the machine is in operation. Turn the lid of the clean water tank tight.
2. Fix the headpiece onto the 75-liter drain water tank, and fasten well (Attention: for ease of use, the operation control panel of the headpiece should face the direction of the suction set of the drain water tank).
3. Referring to the F2 diagram, connect well the metal elbow component, fix the triangular assembly, and adjust to the appropriate direction of operation. Fix well the PU water hose retaining clips, and fix the on/off control to the handle end of the metal elbow hose. Fix well the hexagon nuts. Insert the fast male connector of the metal elbow hose end to the threaded fast female connector of the on/off switch panel.
4. Insert the flexible hose of the suction hose end to the suction hose end, and insert the water hose male connector component to the fast female connector of the outlet of the headpiece water pump.
5. Insert the male connector component of the outlet hose of the clean water tank into the fast female connector of the water inlet of the headpiece water pump.

(The way to insert and pull out the fast male and female connectors: Push forward the threaded sliding button, insert the male connector, then release the sliding button, and it is locked automatically. When disconnection is required, push the threaded sliding button of the female connector and pull out the male connector.)



6. On completing the connections as shown in F3 Diagram, plug in the power, turn on the red suction motor switch, and use this device to vacuum any debris before cleaning:

Attention: When no water is required for carpet cleaning or when the clean water tank is empty, do not turn on the green water pump switch. Otherwise the function of the water pump will be wasted.

7. Plug in the power, turn on the red suction motor switch and the green water pump control switch, and use the hand to hold the control valve. The carpet is now ready for cleaning and for extracting water and moisture. (This device has a high vacuum capacity and the dehydration rate is around 90%). After cleaning, the carpet may be air dried.

The two red on/off “MOTOR 1” and “MOTOR 2” switches of the Headpiece panel in F5 Diagram are the on/off vacuum suction motor control switches for the creation of vacuum suction. The green on/off “PUMP” switch is the control switch of the water pump.

This device may clean carpets of any quality, such as pure wool, synthetics, nylon, plant fiber, woven woolen blankets, and long and short woolen blankets. It can soften the fibers of carpets, recover the bounciness of carpets, and lengthen the life of rubbed and cleansed carpets.

The device uses stainless steel foam-protected mesh so that no foam enters the headpiece during operation. When foam has become excessive, the addition of a foam-dissolving agent or a low foaming chemical is recommended.

Attention: Do not use water at high temperatures when cleaning carpets. The result would be better if lukewarm water is used, especially in relatively cold regions. Never use water with a temperature higher than 40 °C.

When it is fully filled with water, the float will rise to block the air-intake of the headpiece. At such a time, the device may not suck in water in the normal manner, and the water ejected from the nozzle may not be sucked in through the transparent triangular rake. The noise may suddenly become louder. In such a case, turn off the power, take the device to a drainage area, and open the drain water hose to empty the tank of the foul water inside.

When completed, make sure the dirty water in the drain water tank is fully drained. The remaining unused water in the clean water tank should be drained through the outlet at the base. Use a dry towel to clean the body of the device, and replace the power cord on the handle hook of the headpiece.

Terms and Conditions of Warranty

When any Viper product is used within half a year (from the date of the purchase invoice) and if found defective through non-human causes and when determined to be true by our company, the device will be repaired free of charge or parts will be replaced (except vulnerable parts). The following conditions, however, are not covered by the warranty:

1. Product damage caused by improper operation;
2. Self-disassembling or changes made to the device and man-made damages;
3. Man-made damages and/or distortions done to the appearance of the device.

For enquiry on the quality or operation of the product, please contact the service department of our distribution and sales centers in time.



Care and Maintenance

 **Attention:** When care and maintenance is done, make sure the power cord plug is pulled out from the socket.

1. Make sure the power cord is intact.
2. Clean the device after use. Make sure the drain water tank is free of foul water, dirt or dust. Drain off completely any unused water in the clean water tank.
3. After vacuuming, the dust filter must be beaten forcibly.
4. To ensure the water pressure in the pump is good, it is needed to regularly take out the filter at the import point for removing the blockage and take out the filter at the nozzle part for removing the blockage.
5. The stainless steel foam-protection mesh should be regularly cleansed of woolen fluffs to avoid unfavorable effect on suction.
6. After cleaning the dust bag and the dust filter, they must be completely dry when re-used.
7. The motor carbon brush must be replaced when damaged through over-use.
8. Make sure the voltage in use is compatible with that marked on the label of the device.
9. If the power cord is damaged, the after-sales service department must be contacted for replacement in order to avoid danger.

Warning

Safety must be considered at all times when an electrical device is used. In order to ensure safe operation of the device, it is necessary to give it regular care and maintenance.

Our company will not be held responsible for any safety accidents caused by a lack of care and maintenance or by untimely replacement of defective parts.

The following substances must not be used in this device:

Harmful powder, searing substances (for example: burning cigarette, hot ash, inflammable liquids (petrol, solvents, acid and alkali corrosive liquids), inflammable powder (for example: magnesium and aluminum powder)

Power Cord

 If the external socket does not match the plug of the power cord of this device, cut off the plug of this device and fix an appropriate plug in its stead. The wires inside the power cord are labeled in accordance with the following regulations:

Blue wire ----- neutral wire (Zero wire)

Brown wire -----live wire

Yellow-green wire -----earth wire

The blue wire connects with the terminal marked with “N”; the brown wire and the terminal “L” connect with the

device; and the earth wire is marked with “E”.

Parts and accessories are changed without notice.

Circuit Connection Diagram

For circuit connection diagram, refer to “Figure 1” on Page 6.

Product Specification Parameter

For specification parameter, refer to “Form 1”.

CAR275 Specification Parameter (Form1)

Voltage(V)	220~240
Frequency(Hz)	50/60
Power(W)	2000
Vacuum(mmH ₂ O)	2005
Air Flow(ltr/min)	3115
Noise(dBA)	78
Drain Water Tank Capacity(L)	75
Clean Water Tank Capacity(L)	25
Operation Diameter(m)	14m
Power Cord Length(m)	10m



EC Declaration of Conformity



The undersigned, representing the following:

Manufacturer and	the authorised representative established within the European Economic Area:
Company name: Viper Cleaning Equipment Co., Ltd Address: Liang Bian village, Liao Bu town, Dongguan City, Guangdong Province, China	Viper EUROPE Nilfisk-Advance A/S
Business name: Viper Cleaning Equipment Co., Ltd	
Name and address of person/Company authorised to compile the technical file established in the EU Community: Viper EUROPE/Nilfisk-Advance A/S Sognevej 25 DK-2605 Brøndby, Denmark	

herewith declare that the following machinery:

Description of machinery
Generic denomination: Carpet Cleaner
Function: The machine is used for carpet cleaning in commercial area.
Model/s: CAR275-EU/CAR275-UK/CAR275-TR/CAR275

Fulfill the relevant provisions of European Directive 2006/42/EC (MD) and 2006/95/EC (LVD). The harmonized standards used in order to obtain compliance to 2006/42/EC (MD) and 2006/95/EC (LVD) are the following:

EN 60335-1 Safety of household and similar electrical appliances

EN 60335-2-67 Particular requirements for floor treatment and floor cleaning machines, for industrial and commercial use

Place: Dongguan, China

Date: 2013-06-13

Identity and Signature:

Sinan Biltekin
Global Product Manager

Carried Standard: QB1562-1992

VIPER INDUSTRIAL PRODUCTS
P.O.BOX 104 HAMILTON, MI 49419
(866) 418-4737
(866) 41-VIPER

VIPER CLEANING EQUIPMENT CO.,LTD
LIANG BIAN, LIAO BU, DONG GUAN,
GUANG DONG, CHINA
TEL: (0769) 83283988
FAX: (0769) 83280104

