

PT20I

Noblelift Power Electric Pallet Truck With Mast Lift for Order Picking

The PT20I is the ideal choice if transportation operations needs to be combined with health friendly order picking operations.

The low-lift transportation capacity of max. 2000kg is enough to unload delivery lorries and to do picking operations in the warehouse or in the salesroom.

The sideways lifting buttons are ergonomically located nearby the picking area.

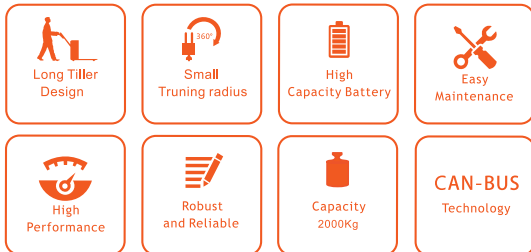

ADVANTAGES

- Power pallet truck with additional health-friendly mast lift.
- AC drive system
- Long tiller for easy and economic operations
- Slow-speed button for safe operations in narrow spaces

**DOUBLE LIFTING DESIGN
CORE COMPONENTS FROM
TOP QUALITY BRANDS**

- Initial lifting
- Easy for operation
- Side-way battery replacement
- Capacities for different applications

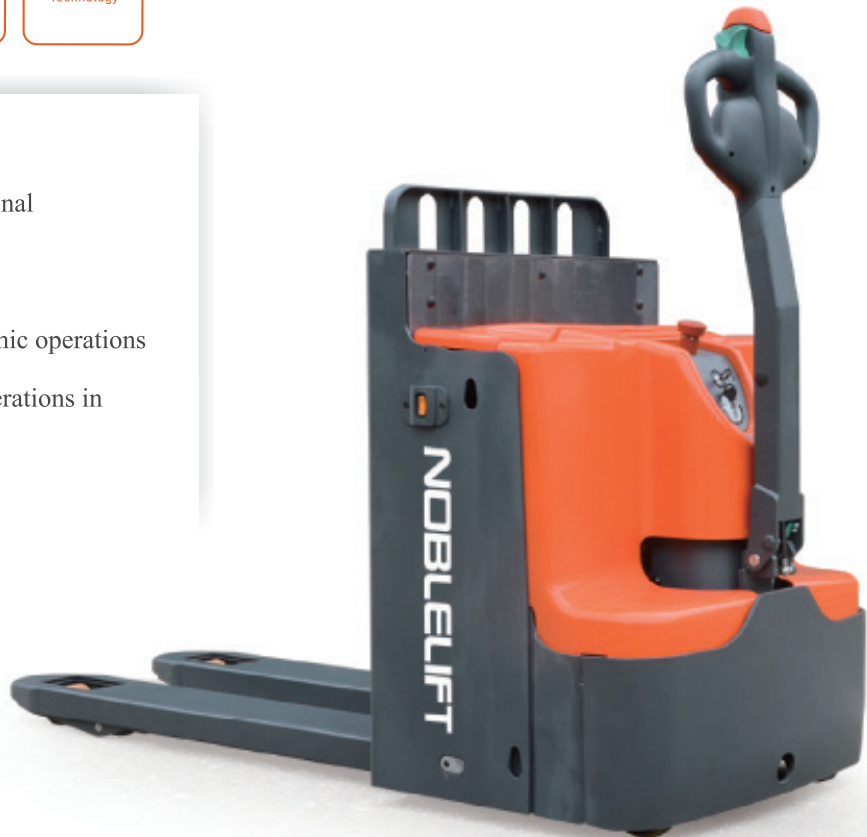

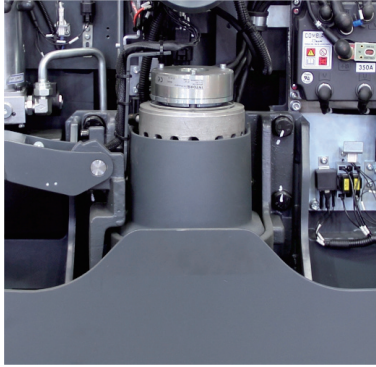

Core Components from top quality brands

German KORDEL gear box, INTORQ brake, WICK drive wheel, Italian ZAPI controller ensure the high performance, efficiency and stability, at the same time reduce the running cost.



Roubust and Reliable Design

The robust chassis with the strong 8mm thick apron protects the truck and the components against mechanical impacts from the outside. The steel battery cover ensures the battery well protected.



Static design of the hydraulic system

There is no movement of the hydraulic system during lifting and lowering of the truck, ensures the stability and safety of the hydraulic system.



Long tiller design

Ergonomically designed long tiller allows comfortable and efficient operator by keeping a safe distance.

CAN-BUS



Initial lifting(double lifting design)

Additional healthy-friendly mast lift height up to 800mm with lift capacity 1000kg, ideal for trailer unloading, short distance material transportation and factory assembly line.



PT201

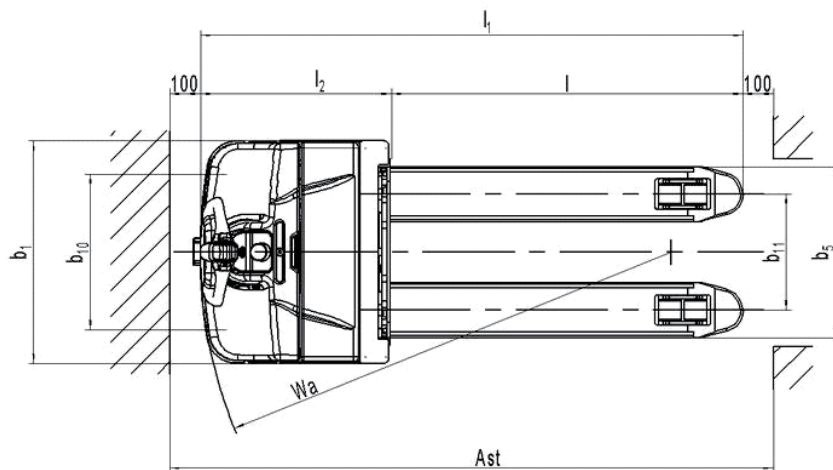
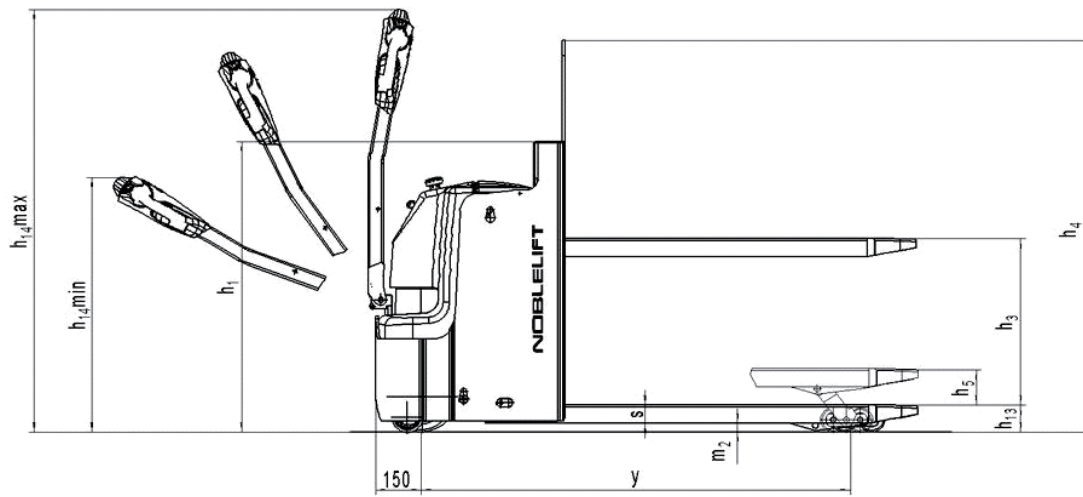

Type sheet for industrial truck acc. to VDI 2198 1KG=2.2LB 1INCH=25.4MM

Identification			
1.2	Manufacturer's type designation		PT20I
1.3	Drive		Battery
1.4	Operator type		Pedestrian
1.5	Load Capacity / rated load	Q (t)	2.0
	Load Capacity / at mast lift	Q (t)	1.0 ¹⁾
	Load Capacity / at support arm lift	Q (t)	2.0 ¹⁾
1.6	Load centre distance	c (mm)	600
1.8	Load distance ,centre of drive axle to fork	x (mm)	916
1.9	Wheelbase	y (mm)	1386
Weights			
2.1	Service weight	kg	656
2.2	Axle loading, laden front/rear	kg	765/1891
2.3	Axle loading, unladen front/rear	kg	476/180
Wheels, Chassis			
3.1	Tires		Polyurethane (PU)
3.2	Tire size,front	Øx w (mm)	Ø230×70
3.3	Tire size,rear	Øx w (mm)	Ø80×70
3.4	Additional wheels(dimensions)	Øx w (mm)	Ø100×40
3.5	Wheels,number front/rear(x=driven wheels)		1x+2/4
3.6	Tread, front	b10 (mm)	510
3.7	Tread, rear	b11 (mm)	380
Basic Dimensions			
4.2	Lowered mast height	h1(mm)	950
4.4	Lift	h3(mm)	550
4.5	Extended maximal height	h4(mm)	1717
4.6	initial lift	h5(mm)	120
4.9	Height of tiller in drive position min./ max.	h14 (mm)	800/1335
4.15	Height, lowered	h13 (mm)	88
4.19	Overall length	l1 (mm)	1770
4.20	Length to face of forks	l2 (mm)	620
4.21	Overall width	b1 (mm)	729
4.22	Fork dimensions	s/e/l (mm)	60/180/1150
4.25	Width across forks	b5 (mm)	560
4.32	Ground clearance, centre of wheelbase	m2 (mm)	28
4.33	Aisle width for pallets1000X1200 crossways	Ast (mm)	1970
4.34	Aisle width for pallets800X1200 lengthways	Ast (mm)	2020
4.35	Turning radius	Wa (mm)	1536
Performance Data			
5.1	Travel speed, laden/ unladen	km/h	6.0/6.0
5.2	Lift speed, laden/ unladen	m/s	0.095/0.015
5.3	Lowering speed, laden/ unladen	m/s	0.090/0.070
5.8	Max. gradeability, laden/ unladen	%	8/20
5.10	Service brake		Electromagnetic
E-Motor			
6.1	Drive motor rating S2 60min	kW	1.3
6.2	Lift motor rating at S3 10%	kW	1.2
6.3	Battery acc. to DIN 43531/ 35/ 36 A, B, C, no		2VBS
6.4	Battery voltage, nominal capacity K5	V / Ah	24/160
6.5	Battery weight	kg	150
6.6	Energy consumption acc. to VDI cycle	kWh/h	0.40
Other Details			
8.1	Type of drive control		AC speed Control
8.4	Sound level at driver's ear acc. to EN 12053	dB(A)	< 70

1)in double-deck operation:mast lift 1.0t,support arm lift 1.0t